



LUMINAIRE TESTING LABORATORY, INC.

SUSTAINING
MEMBER
of the
IESNA

905 Harrison Street · Allentown, PA 18103 · 610-770-1044 · Fax 610-770-8912 · www.LuminaireTesting.com

LTL NUMBER: 13202

DATE: 08-13-2008

PREPARED FOR: EB FLUORESCENT COMPANY, INC.

CATALOG NUMBER: 78N 2/17

LUMINAIRE: FORMED WHITE ENAMEL STEEL HOUSING/REFLECTOR, CLEAR PRISMATIC PLASTIC LENS WITH LINEAR PRISMATIC SIDES.

LAMPS: TWO 17 WATT T8 LINEAR FLUORESCENT LAMPS RATED AT 1325 LUMENS EACH.

LAMP CATALOG NUMBER: GE F17T8/SP41/ECO

BALLAST: ONE UNIVERSAL LIGHTING TECHNOLOGIES B232IUNVHP-B

MOUNTING: SURFACE/PENDANT

TOTAL INPUT WATTS = 29.0 AT 120.0 VOLTS

THE 0 DEGREE PLANE IS PARALLEL WITH THE LAMPS.

#13202

CANDELA DISTRIBUTION

	0.0	22.5	45.0	67.5	90.0
0	591	591	591	591	591
5	588	588	590	590	591
15	568	570	575	578	580
25	527	533	543	552	556
35	466	476	496	507	511
45	380	395	407	406	407
55	231	256	266	255	258
65	104	130	154	166	169
75	53	61	91	119	132
85	17	25	63	99	107
90	0	11	49	75	79
95	0	12	45	59	61
105	0	14	25	28	28
115	1	10	20	24	24
125	1	10	19	24	25
135	2	9	15	18	19
145	2	6	13	16	17
155	2	4	9	12	13
165	2	2	4	6	7
175	1	2	1	2	2
180	1	1	1	1	1

FLUX

56
162
250
308
307
230
147
97
67
39
22
16
14
10
7
4
1
0

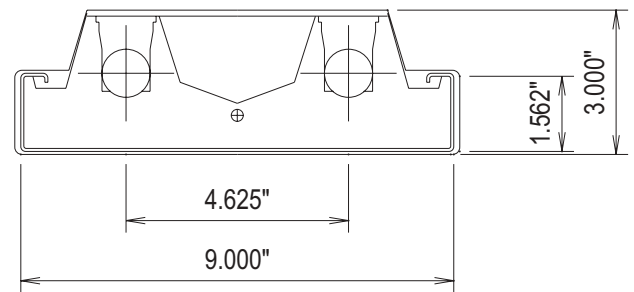

ZONAL LUMEN SUMMARY

ZONE	LUMENS	%LAMP	%FIXT
0- 30	469	17.7	27.0
0- 40	776	29.3	44.6
0- 60	1313	49.6	75.5
0- 90	1624	61.3	93.4
90-120	78	2.9	4.5
90-130	92	3.5	5.3
90-150	110	4.1	6.3
90-180	115	4.3	6.6
0-180	1739	65.6	100.0

TOTAL LUMINAIRE EFFICIENCY: 65.6%
 TOTAL REFLECTANCE OF PAINT: 79.8%
 CIE TYPE: DIRECT
 PLANE: 0-DEG 90-DEG
 SPACING CRITERIA: 1.3 1.3

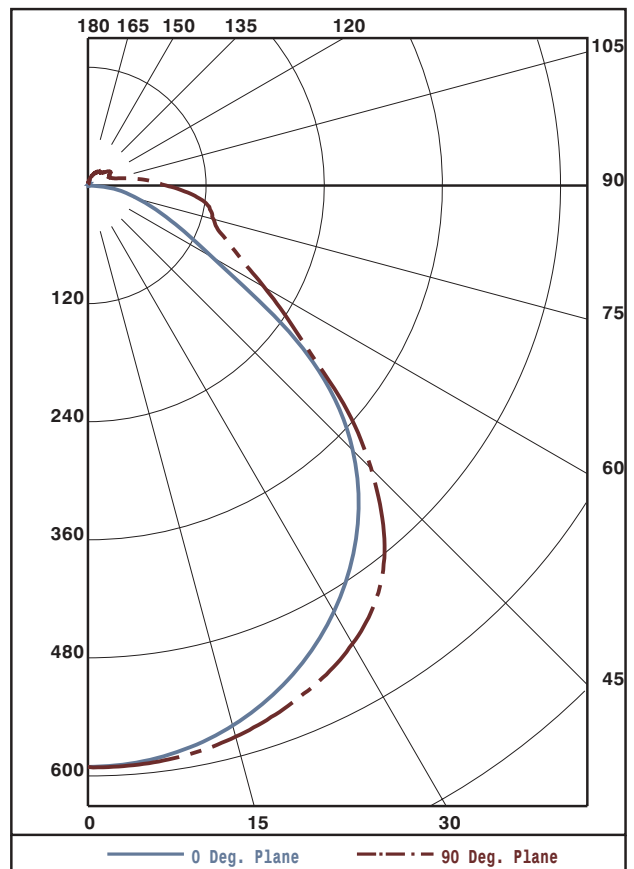

Approved By: MG

THIS REPORT BASED ON LM-41 AND OTHER PERTINENT IESNA PROCEDURES.



LUMINAIRE TESTING LABORATORY, INC.

SUSTAINING MEMBER of the IESNA

905 Harrison Street · Allentown, PA 18103 · 610-770-1044 · Fax 610-770-8912 · www.LuminaireTesting.com

LTL NUMBER: 13202

DATE: 08-13-2008

PREPARED FOR: EB FLUORESCENT COMPANY, INC.

COEFFICIENTS OF UTILIZATION - ZONAL CAVITY METHOD
EFFECTIVE FLOOR CAVITY REFLECTANCE 0.20

Table with columns RC, RW, and rows for angles 0-10 and reflectance values 80, 70, 50, 30, 10, 0.

PLANE: 0-DEG 90-DEG
LUMINOUS LENGTH: 24.000 9.000
HEIGHT OF SIDE: 0.000 1.625

Table with columns ANGLE IN DEG, AVERAGE 0-DEG, AVERAGE 45-DEG, AVERAGE 90-DEG.



LUMINAIRE TESTING LABORATORY, INC.

SUSTAINING MEMBER of the IESNA

905 Harrison Street · Allentown, PA 18103 · 610-770-1044 · Fax 610-770-8912 · www.LuminaireTesting.com

LTL NUMBER: 13202
PREPARED FOR: EB FLUORESCENT COMPANY, INC.

DATE: 08-13-2008

CANDELA DISTRIBUTION

Table with 6 columns representing candela values at various angles (0.0, 22.5, 45.0, 67.5, 90.0) for angles from 0 to 180 degrees.

ZONAL LUMEN SUMMARY

Table with 3 columns representing lumen values for zones from 0-5 to 175-180 degrees.

THIS TEST WAS CONDUCTED USING RELATIVE PHOTOMETRY TECHNIQUES ACCORDING TO STANDARD IESNA PROCEDURES. THE USER MUST THEREFORE USE CAUTION IN THE FOLLOWING SITUATIONS: 1) THIS TEST WAS PERFORMED USING A SPECIFIC BALLAST/LAMP COMBINATION. EXTRAPOLATION OF THESE DATA FOR OTHER BALLAST/LAMP COMBINATIONS MAY PRODUCE ERRONEOUS RESULTS. 2) ACCORDING TO IESNA PROCEDURES, THE BALLAST(S) AND LAMP(S) ARE PRESUMED TO PRODUCE 100% OF RATED OUTPUT. AN APPROPRIATE BALLAST FACTOR MUST BE APPLIED TO THE LUMEN OUTPUT RATINGS AND LUMINOUS INTENSITY VALUES GIVEN. 3) THIS TEST WAS CONDUCTED IN A CONTROLLED LABORATORY ENVIRONMENT WHERE THE AMBIENT TEMPERATURE WAS HELD AT 25°C ±1°C. FIELD PERFORMANCE MAY DIFFER PARTICULARLY IN REGARDS TO CHANGE IN LUMINOUS OUTPUT AS A RESULT OF DIFFERENCE IN AMBIENT TEMPERATURE AND METHOD OF MOUNTING THE LUMINAIRE.