



LUMINAIRE TESTING LABORATORY, INC.

SUSTAINING
MEMBER
of the
IESNA

905 Harrison Street · Allentown, PA 18103 · 610-770-1044 · Fax 610-770-8912 · www.LuminaireTesting.com

LTL NUMBER: 13201

DATE: 08-06-2008

PREPARED FOR: EB FLUORESCENT COMPANY, INC.

CATALOG NUMBER: 78 2/32

LUMINAIRE: FORMED WHITE ENAMEL STEEL HOUSING/REFLECTOR, CLEAR
PRISMATIC PLASTIC LENS WITH LINEAR PRISMATIC SIDES.

LAMPS: TWO 32 WATT T8 LINEAR FLUORESCENT LAMPS RATED AT 2850 LUMENS
EACH.

LAMP CATALOG NUMBER: PHILIPS F32T8/TL841/ALTO

BALLAST: ONE ADVANCE ICN-2P32-SC

MOUNTING: SURFACE

TOTAL INPUT WATTS = 58.3 AT 120.0 VOLTS

THE 0 DEGREE PLANE IS PARALLEL WITH THE LAMPS.

CANDELA DISTRIBUTION

	0.0	22.5	45.0	67.5	90.0
0	1440	1440	1440	1440	1440
5	1438	1435	1434	1437	1437
15	1390	1391	1400	1410	1414
25	1292	1304	1331	1354	1362
35	1143	1172	1218	1251	1262
45	919	953	983	996	996
55	508	559	586	582	572
65	260	298	360	355	343
75	155	169	228	275	295
85	51	70	138	238	266
90	0	24	114	185	201
95	0	25	115	164	180
105	0	34	68	72	71
115	0	25	52	68	71
125	0	22	47	60	62
135	1	17	38	51	53
145	2	11	27	38	41
155	1	6	15	22	24
165	1	3	7	10	11
175	1	1	2	2	3
180	1	1	1	1	1

FLUX

137
396
614
757
744
513
330
239
163

#13201

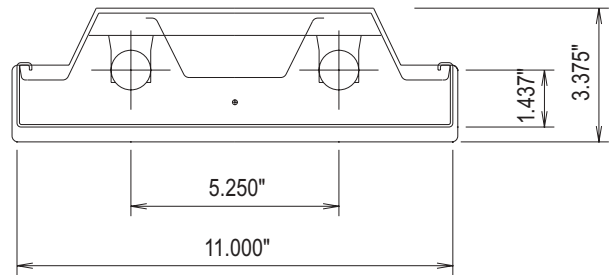

ZONAL LUMEN SUMMARY

ZONE	LUMENS	%LAMP	%FIXT
0- 30	1146	20.1	27.4
0- 40	1903	33.4	45.5
0- 60	3161	55.5	75.5
0- 90	3893	68.3	93.0
90-120	208	3.7	5.0
90-130	244	4.3	5.8
90-150	285	5.0	6.8
90-180	294	5.2	7.0
0-180	4186	73.4	100.0

TOTAL LUMINAIRE EFFICIENCY: 73.4%

TOTAL REFLECTANCE OF PAINT: 82.3%

CIE TYPE: DIRECT
PLANE: 0-DEG 90-DEG
SPACING CRITERIA: 1.3 1.4

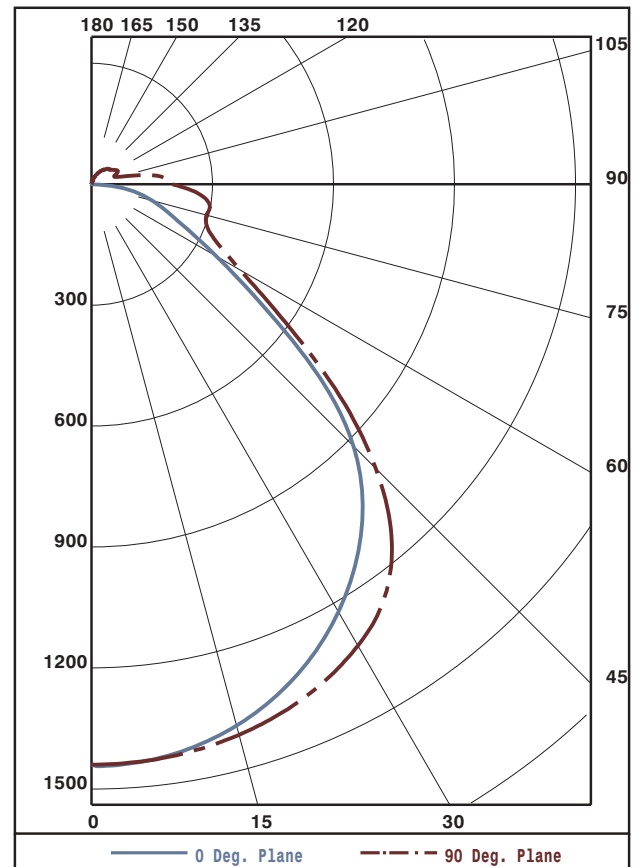

Approved By: MG



LUMINAIRE TESTING LABORATORY, INC.

SUSTAINING MEMBER of the IESNA

905 Harrison Street · Allentown, PA 18103 · 610-770-1044 · Fax 610-770-8912 · www.LuminaireTesting.com

LTL NUMBER: 13201

DATE: 08-06-2008

PREPARED FOR: EB FLUORESCENT COMPANY, INC.

COEFFICIENTS OF UTILIZATION - ZONAL CAVITY METHOD
EFFECTIVE FLOOR CAVITY REFLECTANCE 0.20

Table with 17 columns (RC, RW, and 15 numerical values) and 11 rows (0-10). Values represent utilization coefficients for different room cavity ratios and reflectance levels.

PLANE: 0-DEG 90-DEG
LUMINOUS LENGTH: 48.000 11.000
HEIGHT OF SIDE: 0.000 1.750

Table with 4 columns (ANGLE IN DEG, AVERAGE 0-DEG, AVERAGE 45-DEG, AVERAGE 90-DEG) and 6 rows (0, 45, 55, 65, 75, 85). Values represent average luminance in candela per square meter.



LUMINAIRE TESTING LABORATORY, INC.

SUSTAINING MEMBER of the IESNA

905 Harrison Street · Allentown, PA 18103 · 610-770-1044 · Fax 610-770-8912 · www.LuminaireTesting.com

LTL NUMBER: 13201
PREPARED FOR: EB FLUORESCENT COMPANY, INC.

DATE: 08-06-2008

CANDELA DISTRIBUTION

Table with 6 columns of candela values for various angles from 0 to 180 degrees.

ZONAL LUMEN SUMMARY

Table with 2 columns: Zonal angle ranges and corresponding lumen values.

THIS TEST WAS CONDUCTED USING RELATIVE PHOTOMETRY TECHNIQUES ACCORDING TO STANDARD IESNA PROCEDURES. THE USER MUST THEREFORE USE CAUTION IN THE FOLLOWING SITUATIONS: 1) THIS TEST WAS PERFORMED USING A SPECIFIC BALLAST/LAMP COMBINATION. EXTRAPOLATION OF THESE DATA FOR OTHER BALLAST/LAMP COMBINATIONS MAY PRODUCE ERRONEOUS RESULTS. 2) ACCORDING TO IESNA PROCEDURES, THE BALLAST(S) AND LAMP(S) ARE PRESUMED TO PRODUCE 100% OF RATED OUTPUT. AN APPROPRIATE BALLAST FACTOR MUST BE APPLIED TO THE LUMEN OUTPUT RATINGS AND LUMINOUS INTENSITY VALUES GIVEN. 3) THIS TEST WAS CONDUCTED IN A CONTROLLED LABORATORY ENVIRONMENT WHERE THE AMBIENT TEMPERATURE WAS HELD AT 25°C ±1°C. FIELD PERFORMANCE MAY DIFFER PARTICULARLY IN REGARDS TO CHANGE IN LUMINOUS OUTPUT AS A RESULT OF DIFFERENCE IN AMBIENT TEMPERATURE AND METHOD OF MOUNTING THE LUMINAIRE.